

婺城区白龙桥黄金苑（黄堰头自然村）区块城中村改造建设项目用地红线图

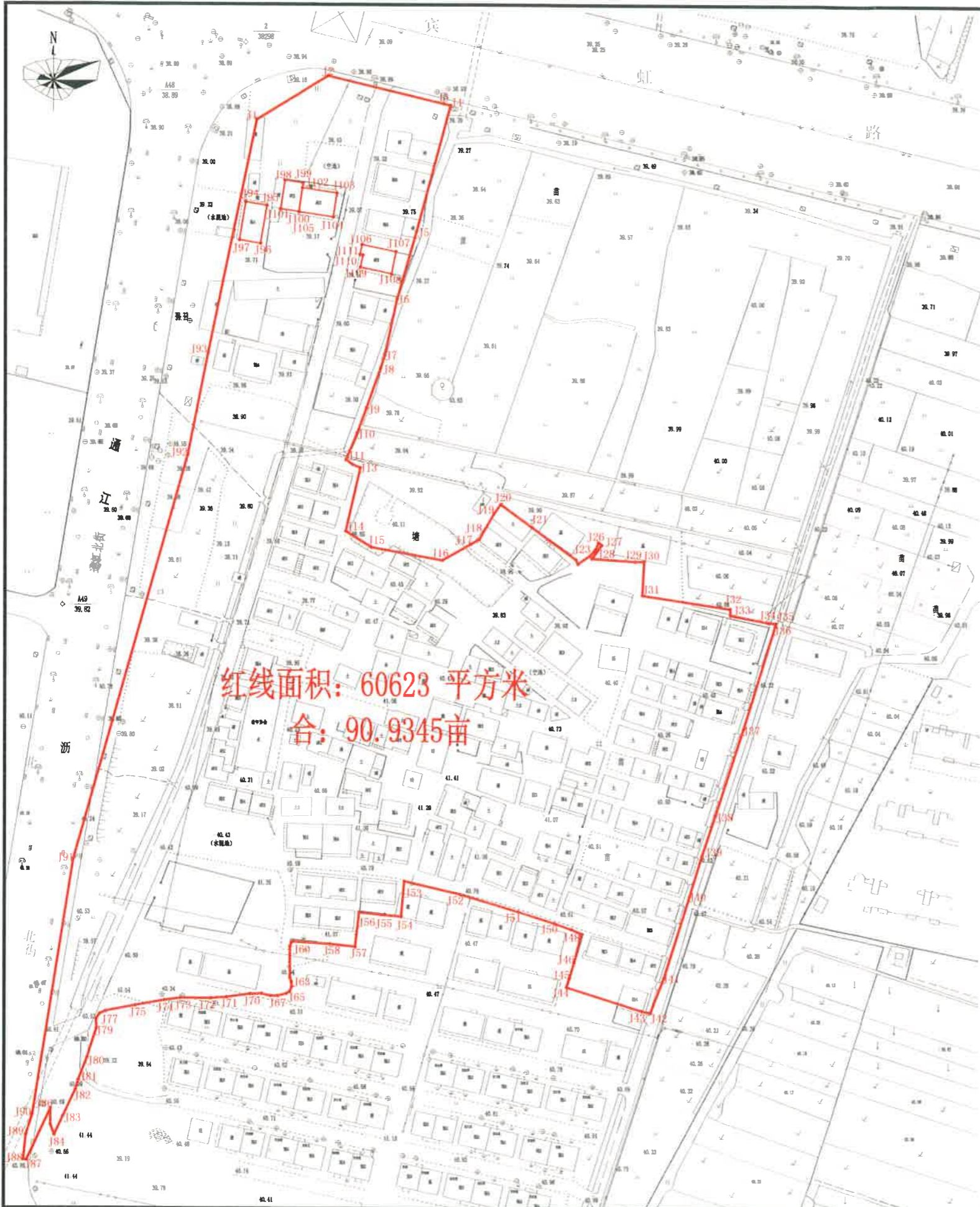

红线面积: 60623 平方米
合: 90.9345 亩

界址点坐标表				界址点坐标表				界址点坐标表			
点号	X	Y	边长	点号	X	Y	边长	点号	X	Y	边长
J1	3219311.315	10156615.325	35.52	J20	3219118.183	10156718.995	16.38	J109	3218999.337	10156831.927	17.98
J2	3219330.050	10156675.508	50.17	J21	3219138.381	10156762.261	23.15	J110	3218982.136	10156829.699	36.28
J3	3219318.255	10156721.580	3.01	J22	3219121.956	10156780.978	2.06	J111	3218917.199	10156818.921	15.82
J4	3219317.552	10156727.508	55.13	J23	3219123.102	10156781.877	6.11	J112	3218932.758	10156813.173	3.97
J5	3219261.029	10156713.077	29.93	J24	3219126.638	10156786.858	3.18	J113	3218933.576	10156809.290	33.19
J6	3219235.269	10156701.797	24.37	J25	3219129.230	10156789.175	3.36	J114	3218913.507	10156777.622	3.91
J7	3219211.146	10156699.618	17.89	J26	3219132.302	10156790.533	1.72	J115	3218917.233	10156778.801	7.22
J8	3219206.039	10156697.833	11.79	J27	3219134.228	10156791.877	7.10	J116	3218951.150	10156780.870	10.02
J9	3219189.139	10156691.981	11.79	J28	3219125.451	10156787.737	18.10	J117	3218963.881	10156783.219	2.31
J10	3219178.385	10156687.906	12.40	J29	3219124.213	10156806.097	3.89	J118	3218966.113	10156783.810	4.73
J11	3219166.932	10156683.152	3.41	J30	3219124.213	10156809.987	11.39	J119	3218968.010	10156779.506	7.15
J12	3219161.978	10156685.913	3.63	J31	3219109.811	10156809.207	37.73	J120	3218970.461	10156772.170	16.25
J13	3219163.551	10156689.280	27.65	J32	3219101.349	10156816.517	2.76	J121	3218975.306	10156756.955	25.98
J14	3219156.913	10156683.067	12.82	J33	3219101.600	10156816.797	16.32	J122	3218982.615	10156732.029	21.31
J15	3219129.822	10156693.937	30.81	J34	3219098.589	10156822.817	3.25	J123	3218988.101	10156708.313	15.09
J16	3219121.390	10156721.267	11.11	J35	3219098.319	10156866.076	1.33	J124	3218973.058	10156707.098	8.51
J17	3219131.396	10156736.517	4.02	J36	3219097.051	10156865.676	15.19	J125	3218973.759	10156698.588	9.11
J18	3219133.389	10156710.037	12.61	J37	3219053.515	10156852.172	38.83	J126	3218960.180	10156687.512	11.69
J19	3219111.806	10156716.231	1.68	J38	3219016.538	10156810.616	18.12	J127	3218960.180	10156687.512	10.73
J20	3219118.183	10156718.995		J39	3218999.337	10156831.927		J128	3218961.319	10156676.871	

界址点坐标表				界址点坐标表				界址点坐标表			
点号	X	Y	边长	点号	X	Y	边长	点号	X	Y	边长
J58	3218961.319	10156676.871	15.87	J77	3218931.291	10156578.907	2.63	J91	3219276.266	10156610.658	9.07
J59	3218962.362	10156661.033	0.76	J78	3218929.191	10156577.172	3.98	J95	3219271.760	10156619.606	16.32
J60	3218962.035	10156660.319	1.95	J79	3218925.210	10156577.563	12.95	J96	3219258.666	10156616.897	9.07
J61	3218960.181	10156659.722	13.31	J80	3218912.876	10156573.600	10.32	J97	3219260.121	10156637.911	16.37
J62	3218916.811	10156659.766	1.61	J81	3218903.279	10156569.812	4.01	J98	3219276.266	10156610.658	
J63	3218915.320	10156660.360	2.13	J82	3218899.377	10156568.751	12.71	S 118 平方米 合 0.222 亩			
J64	3218913.202	10156660.533	2.20	J83	3218887.898	10156563.293	8.76	界址点坐标表			
J65	3218911.169	10156659.689	4.71	J84	3218879.957	10156559.599	1.52				
J66	3218910.237	10156658.252	3.81	J85	3218881.188	10156557.996	7.00	点号	X	Y	边长
J67	3218939.301	10156651.531	3.05	J86	3218891.181	10156557.996	24.16	J98	3219285.518	10156657.187	7.70
J68	3218939.303	10156651.185	3.76	J87	3218889.265	10156547.824	1.39	J99	3219284.312	10156661.799	12.22
J69	3218910.233	10156647.846	4.99	J88	3218889.163	10156546.152	10.63	J100	3219272.255	10156662.979	109.68
J70	3218910.081	10156642.855	10.07	J89	3218880.028	10156547.596	9.07	J101	3219272.255	10156655.363	7.70
J71	3218938.701	10156632.871	6.70	J90	3218888.708	10156550.236	109.68	J102	3219272.255	10156657.187	12.25
J72	3218938.191	10156626.191	12.95	J91	3218897.011	10156567.517	178.39	J103	3219272.255	10156657.187	
J73	3218938.270	10156613.216	6.83	J92	3219169.088	10156616.103	101.21	S 91 平方米 合 0.137 亩			
J74	3218937.336	10156606.180	12.07	J93	3219212.231	10156621.710	101.21	界址点坐标表			
J75	3218935.013	10156599.562	7.88	J11	3219311.315	10156615.325					
J76	3218932.581	10156581.328	12.07	S 151 平方米 合 0.2265 亩							
J77	3218931.391	10156578.907		S 135 平方米 合 0.2025 亩							

2000国家大地坐标系
1985国家高程基准(二期)
制图日期: 2020年8月10日

1:2000

金华智和土地勘测规划有限公司
制图员: 吕超 检查员: 严诗忠

婺城区白龙桥黄金苑（金竹园自然村）区块城中村改造建设项目用地红线图

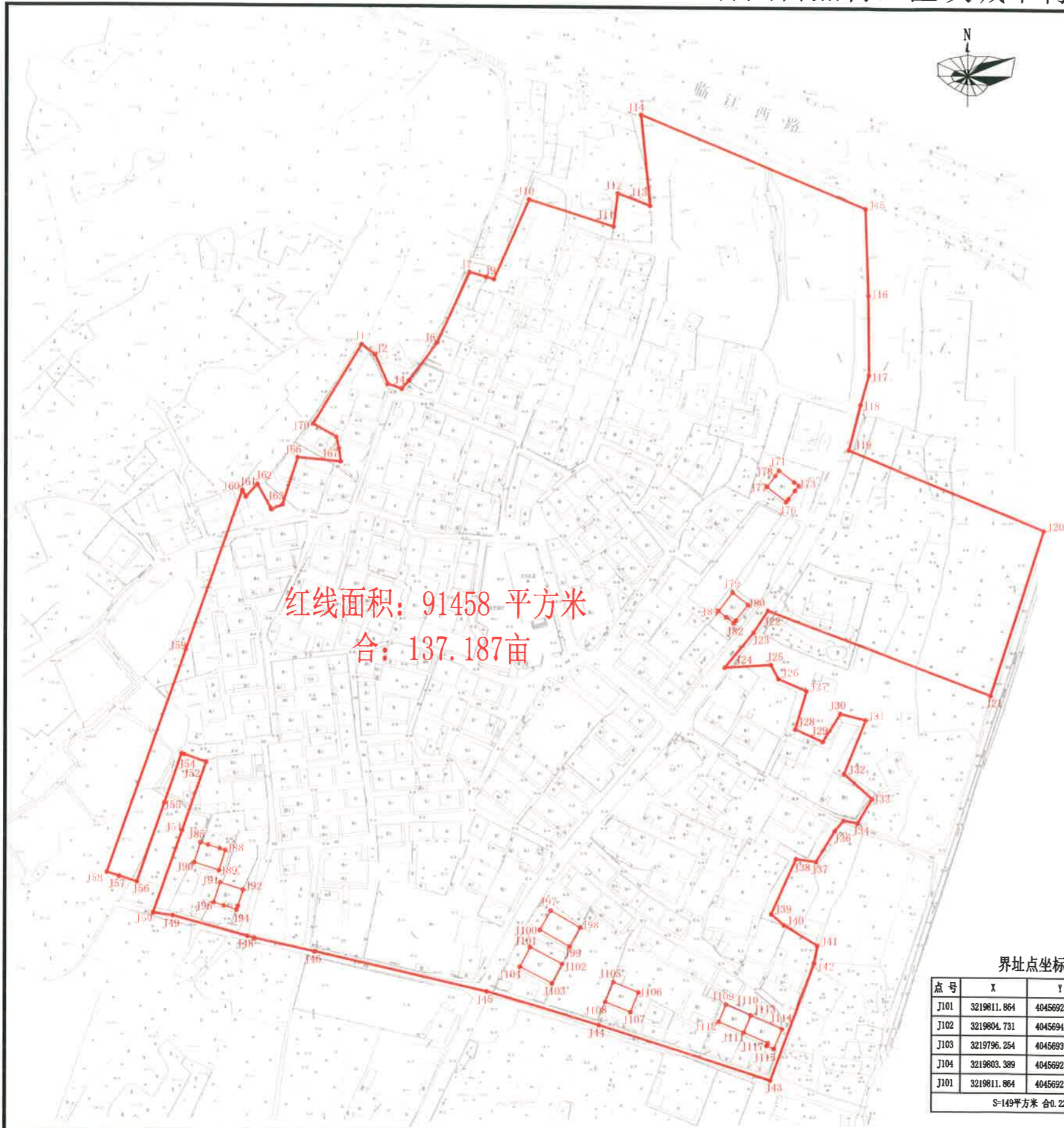

红线面积：91458 平方米
合：137.187亩

界址点坐标表				界址点坐标表				界址点坐标表			
点号	X	Y	边长	点号	X	Y	边长	点号	X	Y	边长
J1	3220072.327	40456853.908	7.31	J20	3219993.615	40457149.689	75.09	J39	3219826.949	40457032.318	7.41
J2	3220067.984	40456859.788	13.96	J21	3219922.049	40457126.969	103.11	J40	3219822.173	40457037.988	16.94
J3	3220055.209	40456865.408	6.22	J22	3219958.175	40457030.399	11.34	J41	3219813.427	40457052.496	7.69
J4	3220053.165	40456871.278	4.78	J23	3219948.703	40457024.158	19.76	J42	3219805.863	40457051.098	54.32
J5	3220056.783	40456874.408	20.60	J24	3219933.412	40457011.638	20.14	J43	3219754.948	40457032.168	78.02
J6	3220073.335	40456886.668	33.58	J25	3219934.752	40457031.738	6.96	J44	3219778.444	40456957.768	50.79
J7	3220103.849	40456900.679	7.48	J26	3219928.667	40457035.118	13.30	J45	3219792.625	40456908.996	26.76
J8	3220101.778	40456907.870	3.42	J27	3219923.494	40457047.368	17.23	J46	3219809.550	40456834.118	3.02
J9	3220100.830	40456911.159	37.62	J28	3219906.968	40457042.488	13.09	J47	3219815.189	40456807.958	33.49
J10	3220135.231	40456926.399	14.47	J29	3219901.550	40457054.408	11.16	J48	3219815.980	40456806.043	8.64
J11	3220123.910	40456962.969	14.87	J30	3219913.741	40457061.998	25.05	J49	3219824.750	40456772.718	37.73
J12	3220138.271	40456964.719	16.17	J31	3219911.032	40457072.828	12.34	J50	3219825.926	40456764.158	31.38
J13	3220133.031	40456978.639	37.44	J32	3219887.734	40457063.618	6.13	J51	3219861.545	40456776.598	10.00
J14	3220172.291	40456974.655	34.40	J33	3219877.045	40457075.748	15.67	J52	3219891.171	40456786.938	36.18
J15	3220132.166	40457071.729	13.21	J34	3219866.399	40457069.508	8.74	J53	3219894.476	40456776.497	7.86
J16	3220094.751	40457073.149	20.42	J35	3219867.556	40457063.488	26.19	J54	3219894.892	40456776.308	5.74
J17	3220060.351	40457073.589	91.29	J36	3219863.092	40457059.758		J55	3219873.497	40456768.919	
J18	3220047.646	40457069.979		J37	3219849.637	40457051.718		J56	3219839.300	40456757.108	
J19	3220027.832	40457065.049		J38	3219850.831	40457043.058		J57	3219841.665	40456749.613	
J20	3219993.615	40457149.689		J39	3219826.949	40457032.318		J58	3219843.392	40456744.138	

界址点坐标表				界址点坐标表				界址点坐标表			
点号	X	Y	边长	点号	X	Y	边长	点号	X	Y	边长
J58	3219843.392	40456744.138	102.37	J71	3220018.949	40457035.001	8.30	J85	3219856.326	40456764.631	3.38
J59	3219939.963	40456778.088	73.11	J72	3220013.927	40457041.604	2.46	J86	3219855.330	40456787.861	5.35
J60	3220008.930	40456802.338	3.16	J73	3220012.442	40457043.560	2.77	J87	3219853.753	40456792.972	2.51
J61	3220006.164	40456803.868	7.36	J74	3220010.225	40457041.903	4.52	J88	3219853.026	40456795.376	9.09
J62	3220011.590	40456808.838	11.92	J75	3220006.655	40457039.130	1.60	J89	3219844.348	40456792.683	11.26
J63	3220001.195	40456814.664	0.60	J76	3220006.343	40457038.223	10.64	J90	3219847.717	40456781.939	9.02
J64	3220000.670	40456819.958	5.24	J77	3220011.792	40457029.759	5.94				
J65	3220002.870	40456819.718	21.47	J78	3220016.555	40457033.309	2.93				
J66	3220023.310	40456826.278	18.80								
J67	3220021.590	40456844.998	5.88								
J68	3220027.419	40456844.218	5.06								
J69	3220032.323	40456842.968	11.43								
J70	3220037.836	40456832.958	40.36								
J71	3220072.327	40456853.908									
S=92449 平方米 合138.6735亩				S=94平方米 合0.141亩				S=102平方米 合0.153亩			

界址点坐标表				界址点坐标表				界址点坐标表			
点号	X	Y	边长	点号	X	Y	边长	点号	X	Y	边长
J79	3219827.708	40456936.639	14.71	J79	3219965.887	40457015.005	8.42	J91	3219839.081	40456793.164	10.45
J98	3219820.527	40456949.476	9.48	J80	3219960.766	40457021.688	8.67	J92	3219835.916	40456803.119	7.30
J99	3219812.256	40456944.849	14.71	J81	3219953.888	40457016.411	1.45	J93	3219828.964	40456800.903	1.78
J100	3219819.398	40456931.985	9.52	J82	3219952.735	40457015.527	4.20	J94	3219827.272	40456800.357	5.91
J97	3219827.708	40456936.639		J83	3219955.293	40457012.193	4.22	J95	3219829.086	40456794.732	4.56
S=149平方米 合0.2235亩				S=140平方米 合0.21亩				S=85平方米 合0.1275亩			

界址点坐标表				界址点坐标表				界址点坐标表			
点号	X	Y	边长	点号	X	Y	边长	点号	X	Y	边长
J101	3219811.864	40456927.808	15.58	J105	3219797.082	40456964.041	11.70	J109	3219787.664	40457012.761	11.73
J102	3219804.731	40456941.654	9.55	J106	3219792.715	40456978.892	9.23	J110	3219783.076	40457023.554	8.02
J103	3219796.254	40456937.254	15.58	J107	3219784.153	40456971.441	11.67	J111	3219775.640	40457020.537	11.84
J104	3219803.389	40456923.409	9.55	J108	3219788.426	40456960.581	9.32	J112	3219780.251	40457009.627	8.05
J101	3219811.864	40456927.808		J105	3219797.082	40456964.041		J109	3219787.664	40457012.761	
S=149平方米 合0.2235亩				S=108平方米 合0.162亩				S=95平方米 合0.1425亩			

界址点坐标表			
点号	X	Y	边长
J113	3219783.041	40457023.642	14.75
J114	3219777.278	40457037.223	9.35
J115	3219768.672	40457033.578	3.32
J116	3219769.983	40457030.524	1.30
J117	3219771.155	40457031.078	11.45
J111	3219775.640	40457020.537	8.03
J113	3219783.041	40457023.642	
S=123平方米 合0.1845亩			

2000国家大地坐标系
1985国家高程基准(二期)
制图日期：2020年8月10日

1:2000

金华智和土地勘测规划有限公司
制图员：吕超 检查员：严诗忠

婺城区白龙桥黄金苑（渎仁自然村）区块城中村改造建设项目用地红线图



点号	X	Y	边长	点号	X	Y	边长	点号	X	Y	边长	点号	X	Y	边长
J1	3219549.035	40456715.976		J20	3219589.890	40456810.254		J39	3219469.134	40456871.308		J58	3219400.532	40456805.183	
J2	3219543.166	40456734.817	19.73	J21	3219565.330	40456793.528	29.71	J40	3219470.619	40456874.445	3.47	J59	3219398.371	40456790.033	15.30
J3	3219531.424	40456752.757	21.44	J22	3219522.569	40456762.422	52.88	J41	3219471.471	40456878.387	4.03	J60	3219395.183	40456770.761	19.53
J4	3219532.309	40456755.757	3.13	J23	3219515.831	40456773.579	13.03	J42	3219471.306	40456881.355	2.97	J61	3219392.191	40456752.698	18.31
J5	3219538.309	40456764.077	10.26	J24	3219515.509	40456775.105	1.56	J43	3219469.326	40456886.782	5.78	J62	3219383.526	40456748.830	9.49
J6	3219543.229	40456764.597	4.95	J25	3219516.299	40456777.720	2.73	J44	3219470.255	40456887.574	1.22	J63	3219372.659	40456742.532	12.56
J7	3219547.669	40456764.077	4.47	J26	3219509.861	40456793.103	16.68	J45	3219470.675	40456889.306	1.78	J64	3219372.342	40456938.993	202.08
J8	3219551.830	40456763.317	4.23	J27	3219499.213	40456818.517	27.55	J46	3219462.866	40456895.398	9.90	J65	3219323.434	40456938.416	1.99
J9	3219555.710	40456763.557	3.89	J28	3219488.719	40456818.397	10.49	J47	3219459.072	40456896.961	4.10	J66	3219381.919	40456695.083	250.26
J10	3219577.030	40456770.597	22.45	J29	3219472.738	40456822.130	16.41	J48	3219451.714	40456897.971	7.43	J67	3219419.417	40456673.267	43.38
J11	3219582.470	40456774.237	6.55	J30	3219467.031	40456823.997	6.00	J49	3219449.512	40456897.993	2.20	J68	3219488.166	40456695.920	72.39
J12	3219585.590	40456780.477	6.98	J31	3219463.566	40456825.947	3.98	J50	3219439.517	40456897.774	10.00	J69	3219487.108	40456697.227	1.68
J13	3219584.309	40456785.397	5.08	J32	3219462.215	40456827.389	1.98	J51	3219424.415	40456862.671	38.21	J70	3219498.446	40456699.307	11.53
J14	3219578.830	40456793.997	10.20	J33	3219461.627	40456830.315	2.98	J52	3219419.110	40456850.251	13.51	J71	3219499.793	40456699.751	1.42
J15	3219578.830	40456796.077	2.08	J34	3219459.913	40456843.712	13.51	J53	3219413.166	40456836.431	15.04	J72	3219497.751	40456699.409	2.07
J16	3219592.629	40456807.998	18.23	J35	3219459.291	40456851.173	7.49	J54	3219409.684	40456828.122	9.01	J73	3219491.628	40456698.383	6.21
J17	3219601.950	40456814.238	11.22	J36	3219459.929	40456854.098	2.99	J55	3219408.962	40456825.197	3.01	J74	3219480.717	40456742.616	45.56
J18	3219605.870	40456818.158	5.54	J37	3219461.924	40456858.125	4.49	J56	3219408.432	40456820.333	4.89	J75	3219494.790	40456743.439	14.10
J19	3219607.626	40456822.275	4.48	J38	3219467.565	40456868.723	12.01	J57	3219405.854	40456818.418	3.21	J76	3219509.222	40456747.457	14.98
J20	3219589.890	40456810.254	21.43	J39	3219469.134	40456871.308	3.02	J58	3219400.532	40456805.183	14.27	J77	3219523.353	40456756.138	16.58

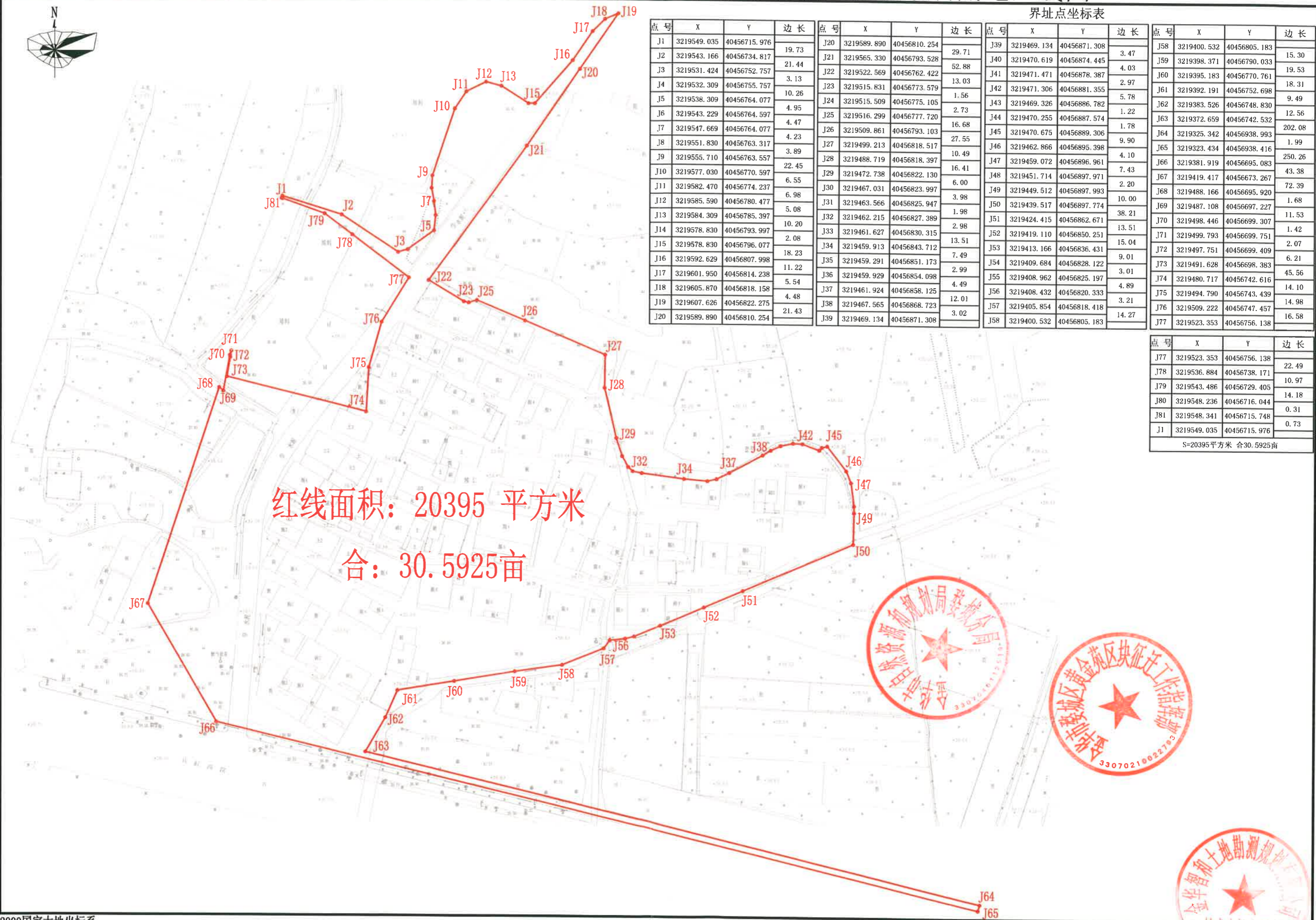

红线面积：20395 平方米
合：30.5925亩

点号	X	Y	边长
J77	3219523.353	40456756.138	22.49
J78	3219536.884	40456738.171	10.97
J79	3219543.486	40456729.405	14.18
J80	3219548.236	40456716.044	0.31
J81	3219548.341	40456715.748	0.73
J1	3219549.035	40456715.976	
S=20395平方米 合30.5925亩			

